

FOR LEASE



plat:form  
Platform Properties Ltd

# Prosperity Ridge

1185 Prosperity Way, Williams Lake, BC



Connor O’Keeffe 604 628 4339  
cokeeffe@nwaretail.com

Brodie Henrichsen 604 628 4331  
bhenrichsen@nwaretail.com

Marketed by Northwest Atlantic (B.C.) Broker Inc.  
Developed by Platform Properties Ltd.

www.nwaretail.com  
www.platformproperties.ca

## Photo



## Project Description

Prosperity Ridge is an exciting new shopping centre located beside the Walmart Supercentre on Prosperity Way in Williams Lake. A number of retailers have recently opened, including Winners and SportChek.

When fully developed, the centre will offer over 100,000 square feet of retail space with a variety of opportunities including large and mid sized boxes, commercial retail units and freestanding pad buildings.

The project is located on the south side of Williams Lake near Canadian Tire and Wholesale Club. The site is located on Prosperity Way accessed from South Lakeside Drive via Highway 20.

## Location

Situated 286 km north of Kamloops and 238 km south of Prince George, Williams Lake has earned its nickname "The Hub of the Cariboo".

Routing thousands of travellers north and south each year, Highway 97 is BC's major interior route for tourism and commerce.

Williams Lake services two regional districts: the Cariboo Regional District and the Central Coast District population. The commercial retail and service market in Williams Lake is supported by a consumer population of over 18,000 people and over 45,000 people regionally. Main industries include transportation, agriculture, mining and forestry.

Site plan

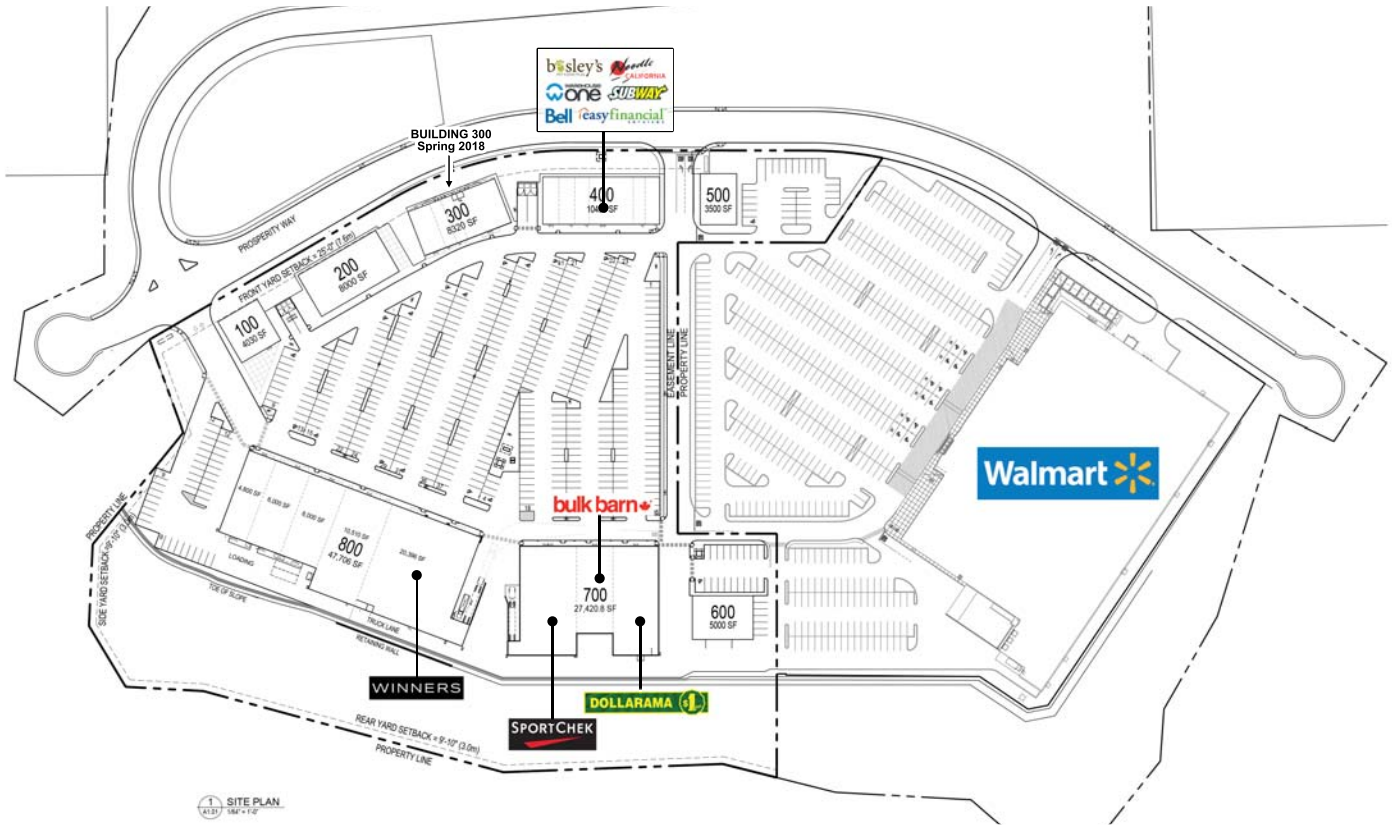

Timing

> Next phase - Spring 2018

Parking Ratio

> 4.8 / 1,000 square feet



Plans and specifications are subject to change without written notice. E.&O.E.: All information furnished regarding property for sale, rental or financing is from sources deemed reliable, but no warranty or representation is made as to the accuracy thereof and same is submitted to errors, omissions, change of price, rental or other conditions, prior sale, lease or financing or withdrawal without notice.

# Demographics

NWAC CENSUS SUMMARY

		Primary Trade Area	Secondary Trade Area
POPULATION	Population	18,354	17,994
	Median Age	42.9	51.2
HOUSEHOLDS	Households	7,615	7,632
	Growth 2011 - 2016	0.4%	-0.8%
	Projected Growth 2016 - 2021	0.8%	-0.1%
INCOME	Average Household Income	\$ 93,778	\$ 74,515
	Median Household Income	\$ 78,035	\$ 55,999
BUSINESS	Workplace Population	13,039	3,917
	Total Daytime Population (Workplace Pop + Daytime Pop)	22,018	13,320
EDUCATION	No Certificate, Diploma or Degree	23.5%	26.5%
	High School Certificate	31.4%	30.1%
	Bachelor's Degree or Higher	13.4%	10.2%
ETHNICITY	Caucasian or Aboriginal	96.1%	98.6%
	Black	0.0%	0.2%
	Asian	1.7%	0.9%
	South Asian	1.9%	0.1%
	Latin American	0.2%	0.1%
	Arab	0.0%	0.0%
	Other	0.0%	0.1%

This report was produced using data from private and government sources deemed to be reliable. The information herein is provided without representation or warranty.

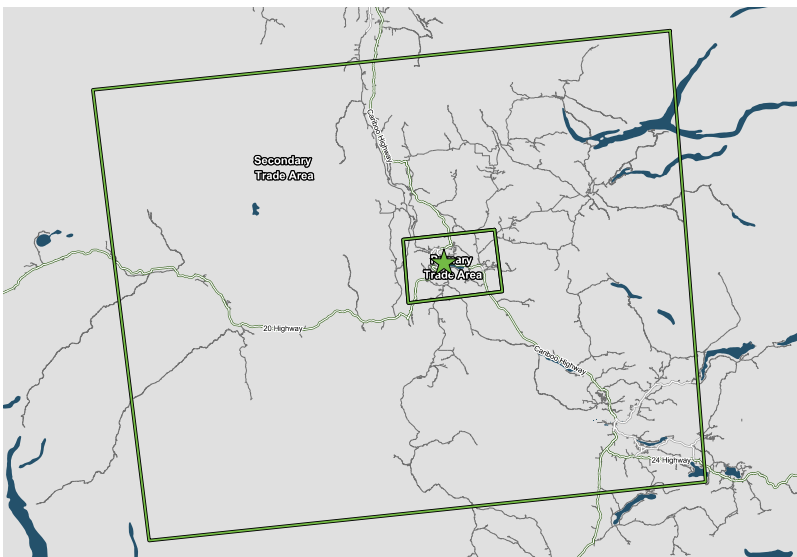

Brodie Henrichsen | Principal  
 604 628 4331  
[bhenrichsen@nwaretail.com](mailto:bhenrichsen@nwaretail.com)

Connor O’Keeffe | Junior Associate  
 604 628 4339  
[cokeeffe@nwaretail.com](mailto:cokeeffe@nwaretail.com)